

A = 28"  
 B = 25 1/8"  
 C = 29 3/4"  
 D = 25 3/8"  
 E = 26"  
 F = 27 3/8"  
 G = 25 1/8"  
 H = 26 1/4"  
 I = 33"  
 J = 35"

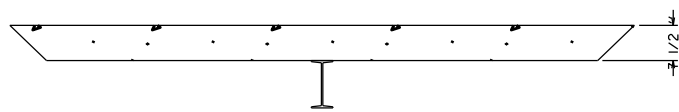

Twin Channels  
 Beams # 2,4,6,8,10, & 11



Beams  
 Beam # 1,3,5,7 & 9

10/18/2017 - EJW, JCJ & JRT - Br. # 17334